

Assembly Instruction

Parts List

A table leg 4pcs

B table top 1pc

C cross brace of leg 2pcs

D cross brace of table leg 2pcs

E 2sets ER EL

F seat board 4pcs

Four pairs of left and right legs

G cross brace of seat leg 4pcs

Hardware List

① 8*80mm 8pcs	② 8*95mm 8pcs	③ 8*65mm 16pcs
④ 8*100mm 8pcs	⑤ 4*40mm 12pcs	

STEP 1

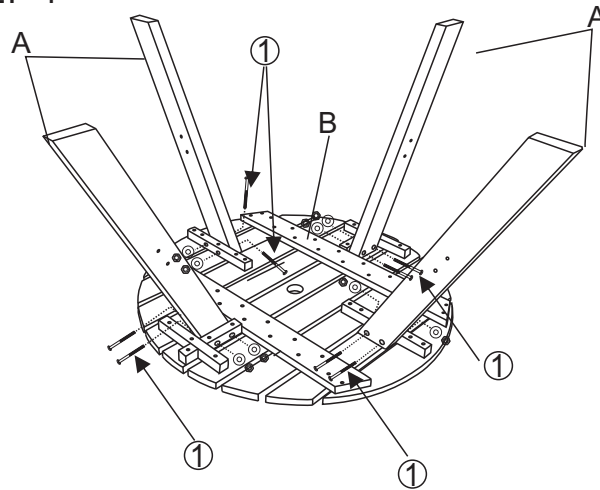

Fix four table legs A to the table top B by using 8 sets of bolt and washer and nut ①, reference the drawing.

① = 8pcs

STEP 2

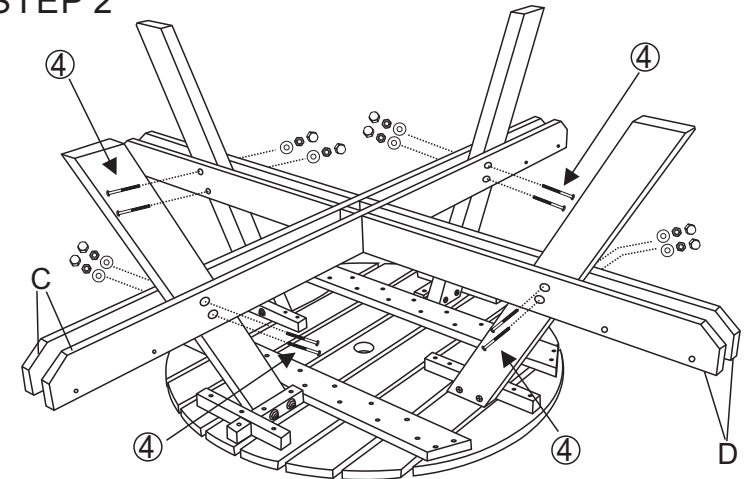

Fix two pieces cross brace C of table leg A and two pieces cross brace D of table leg A by using 8 sets of bolts, washer, nut and hat ④. Note the difference of part C and D, reference the drawing.

④ = 8pcs

STEP 3

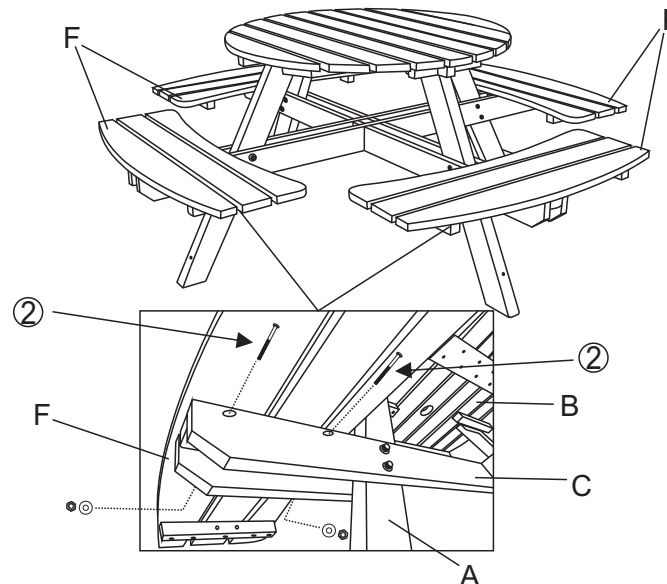

Turn up the finished frame to fix the seat F to cross brace C and D by using 8 sets of bolts, washer and nut ②. Reference the drawing.

② = 8pcs

STEP 4

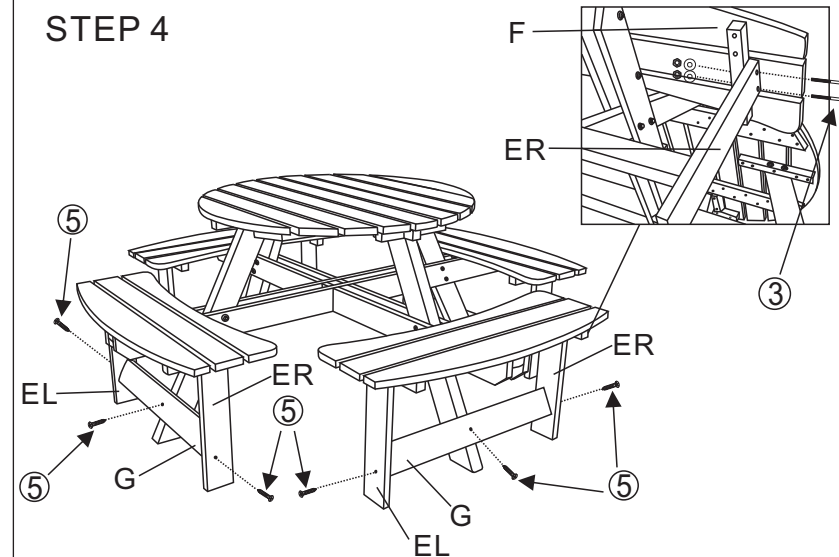

Fix four pairs of left leg and right legs ER and EL to the seat board by using 16 sets of bolt and washer ③, do not fasten the bolts set before the cross brace of seat leg fixed. Fix four pieces brace of seat leg G between the seat legs by using 12 pieces screws ⑤. Reference the drawing.

③ = 16pcs

⑤ = 12pcs