



Assembly Instructions

P760 Power Dynamics™ 30" Flip-It Snow Blade

STEP 1

Before beginning assembly, you should have:

Assembly Tools

Philips Screwdriver



Wrench or Pliers



Product Components

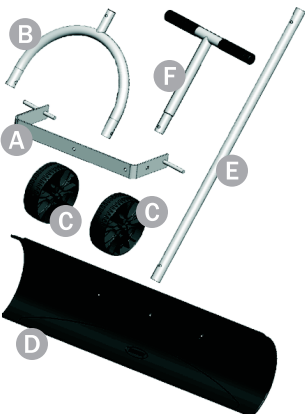

- A Pivot Bracket
- B Blade Tube
- C Wheels (2)
- D 30" Blade
- E Main Tube
- F T-Handle

Hardware Pack

- X **6X**
1/4" x 1 1/2" Carriage Screws
- Y **6X**
1/4" Nylock Nuts
- Z **2X**
Pushcaps

STEP 2

Attach Rotating blade tube using (1) 1 1/2" Carriage bolt and (1) 1/4" Nylock Nut

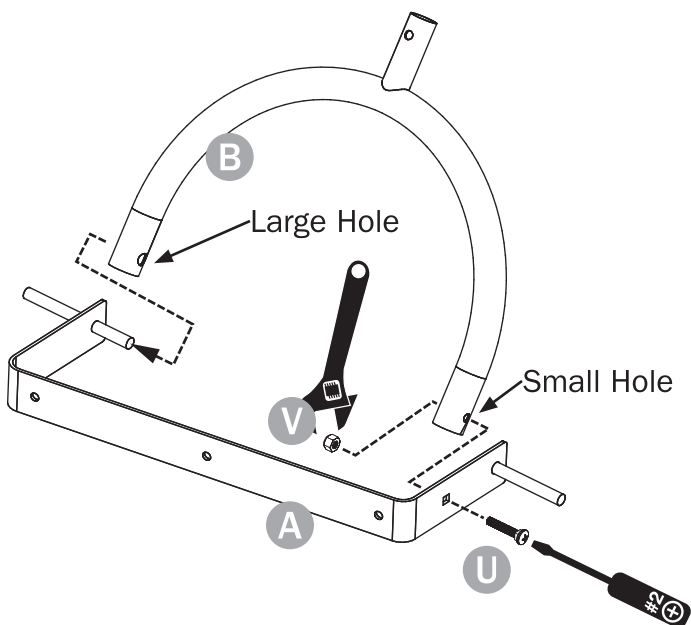

STEP 3

Attach Wheels to Pivot bracket using (2) Push caps

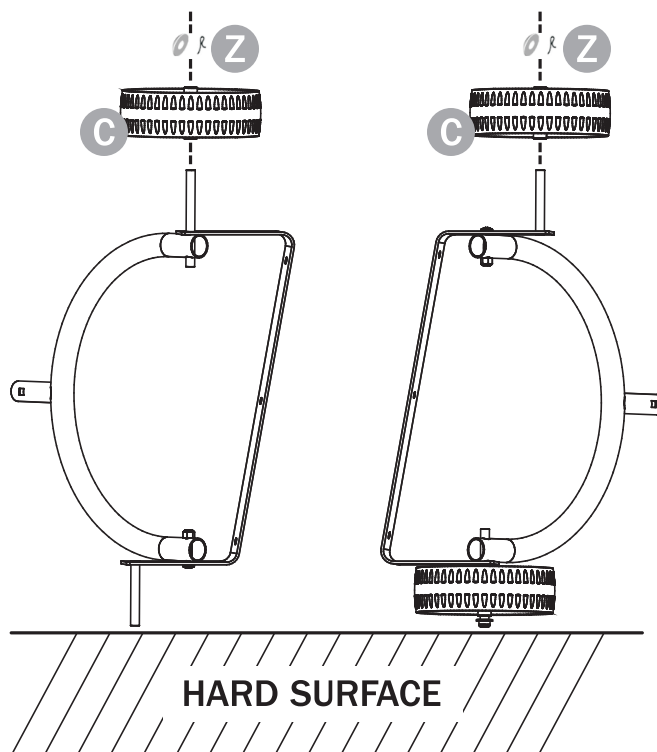

Missing a part?

Please do not return to your store. Your local retailer does not stock parts.

Your complete satisfaction is our #1 priority! Call us and we will ship the parts you need.

Parts Hotline:
1-877-283-7839

STEP 4

Attach blade to pivot bracket with (3) 1 ½" screws and (3) ¼" Nylock Nuts

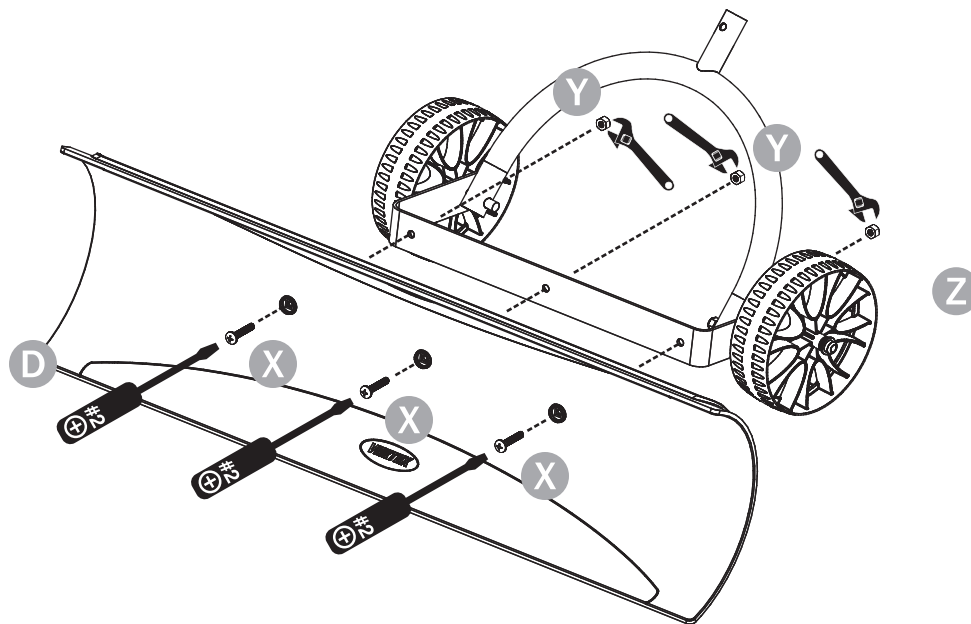

STEP 5

Attach main tube to blade tube with (1) 1 ½" Carriage bolt and (1) ¼" Nylock Nut

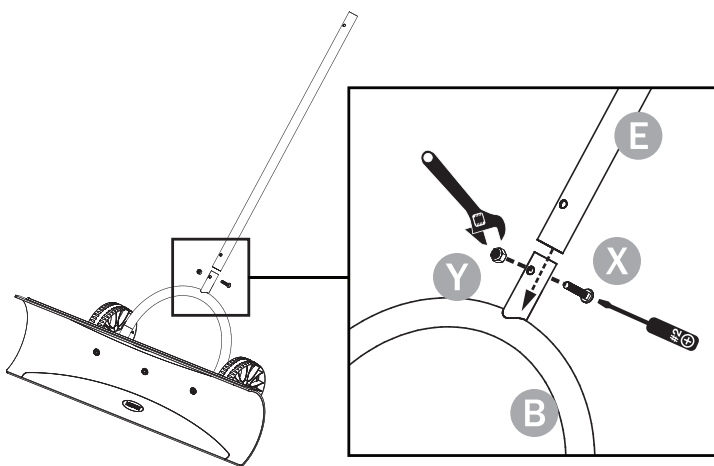

STEP 6

Attach T-handle to main tube with (1) 1 ½" Carriage screw and (1) ¼" Nylock Nut

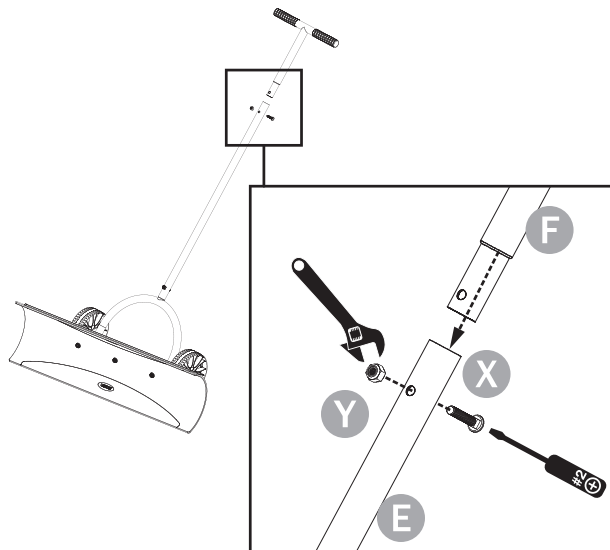

STEP 7

Tighten all fasteners. Review safety and warranty information.

Limited Warranty

Vertex International warrants this product against defects in materials or workmanship during normal use for 1 year(s) from date of purchase.

Call 1-877-283-7839 and Vertex will repair or replace the product at Vertex's sole discretion.

Vertex shall not be liable for incidental or consequential damage resulting from the use of this product. Vertex does not assume responsibility for defects, damage, or injury caused by misuse, abuse or alterations.

Vertex makes no warranty with respect to the suitability of this product for specific applications. We recommend the end-user determine such suitability for any specific use.